

Transient Voltage Suppressors for ESD Protection

SE05T2C12GZ

Features

- ◆ Working voltage : 5.0V
- ◆ Low capacitance: 0.7pF (Typical)
- ◆ Low leakage current: 1.0μA @ V_{RWM}
- ◆ Low clamping voltage
- ◆ Response Time is < 1 ns

SOT23-3L



Applications

- ◆ Power Management
- ◆ Industrial Application
- ◆ Power Supply Protection
- ◆ Many other portable devices

Circuit Diagram

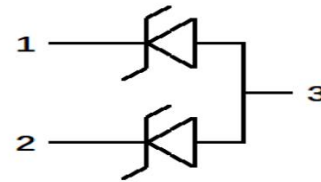

Mechanical Characteristics

- ◆ SOT23-3L Package
- ◆ Quantity Per Reel : 3,000pcs
- ◆ Reel Size : 7 inch

Absolute Maximum Rating

Symbol	Parameter	Value	Units
T_{STG}	Storage Temperature Range	-55 to +150	°C
T_{OPT}	Operating Temperature Range	-55 to +125	°C
V_{ESD}	ESD per IEC 61000-4-2(Air)	±20	KV
	ESD per IEC 61000-4-2 (Contact)	±15	

Transient Voltage Suppressors for ESD Protection

SE05T2C12GZ

I-V Curve Characteristics

Symbol	Parameter
I_{PP}	Maximum Reverse Peak Pulse Current
V_C	Clamping Voltage @ I_{PP}
V_{RWM}	Working Peak Reverse Voltage
I_R	Maximum Reverse Leakage Current @ V_{RWM}
V_{BR}	Breakdown Voltage @ I_T
I_T	Test Current

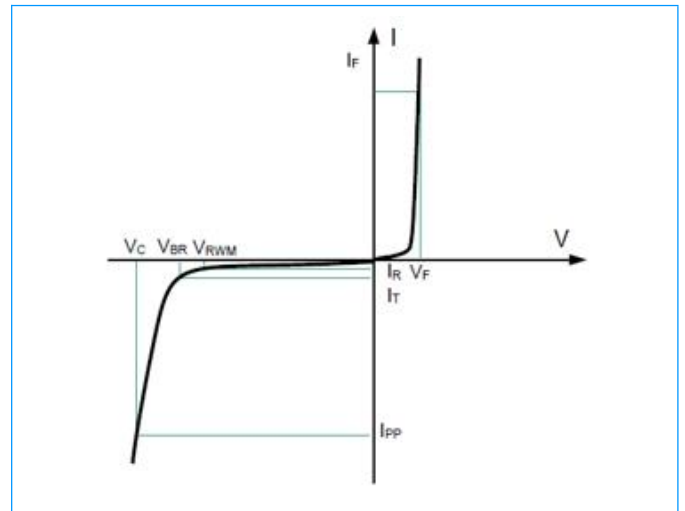

Electrical Characteristics (@ $T_A=25^\circ\text{C}$ Unless Otherwise Specified)

Symbol	Test Condition	Minimum	Typical	Maximum	Units
V_{RWM}	--	--	--	5	V
I_R	$V_{RWM}=5\text{V}$, $T=25^\circ\text{C}$	--	--	1.0	μA
V_{BR}	$I_T = 1\text{mA}$	6	7.5	9.0	V
V_C	$I_{PP}=4\text{A}$, $t_p=8/20\mu\text{s}$	--	--	15	V
C_J	$V_R = 0\text{V}$, $f = 1\text{MHz}$, 1,2to 3	--	0.7	--	pF

Transient Voltage Suppressors for ESD Protection

SE05T2C12GZ

SOT23-3L Package Outline & Dimensions

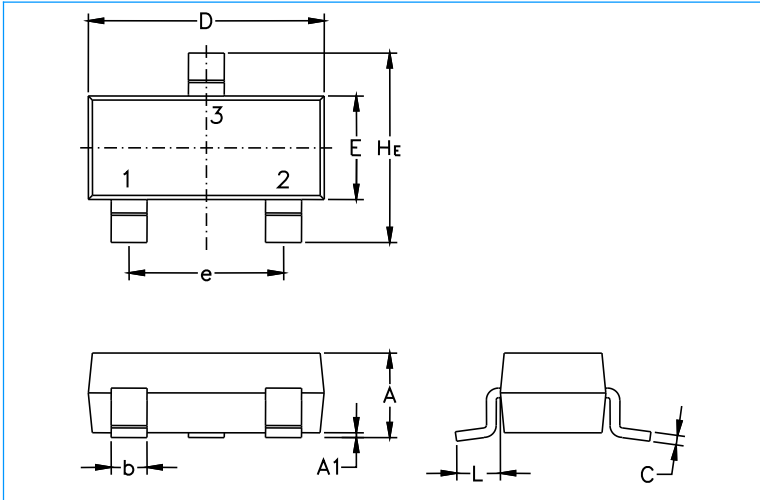

Symbol	Millimeters			Inches		
	Min.	Nom.	Max.	Min.	Nom.	Max.
A	0.89	1.00	1.11	0.035	0.040	0.044
A1	0.01	0.06	0.10	0.001	0.002	0.004
b	0.37	0.44	0.50	0.15	0.18	0.020
c	0.09	0.13	0.18	0.003	0.005	0.007
D	2.80	2.90	3.04	0.110	0.114	0.120
E	1.20	1.30	1.40	0.047	0.051	0.055
e	1.78	1.90	2.04	0.070	0.075	0.081
L	0.35	0.54	0.69	0.014	0.021	0.029
He	2.10	2.40	2.64	0.083	0.094	0.104

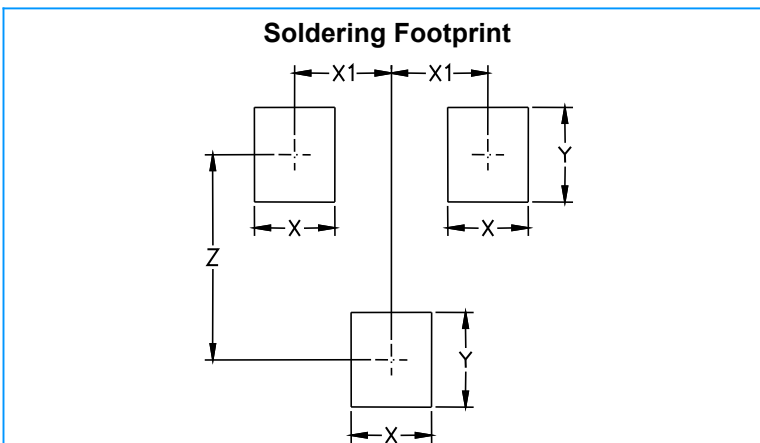

Symbol	Millimeters	Inches
X	0.80	0.031
X1	0.95	0.037
Y	0.90	0.035
Z	2.00	0.079

Ordering Information

Part Number	Package	Packing Type
SE05T2C12GZ	SOT23-3L	Tape & Reel 3000PCS /7" Reel